

APPENDIX A



North Harrow Area Parking Review

STATUTORY CONSULTATION

IMPORTANT – THIS AFFECTS YOU – PLEASE READ

North Harrow Area Parking Consultation

What is this about?

An informal public consultation was conducted in September 2013 to review the current parking issues in the wider North Harrow area.

The results of the informal public consultation were presented to the Traffic and Road Safety Advisory Panel (TARSAP) on 5th February 2014. TARSAP were asked to approve the recommendations made in the report and to move forward to the next step which is formal Statutory Consultation. The recommendations were based on the responses from the residents and businesses during the consultation. TARSAP agreed some minor amendments to the recommendations presented and these were approved by the Portfolio Holder for Community Safety and Environment.

The recommendations, TARSAP report, survey results and the approved minutes of the meeting can be viewed on the Harrow Council website at - <http://tinyurl.com/og14ebz>

The link will need to be entered into your web browser. If you do not have personal access to the internet the council public libraries do have internet access that residents may use. Alternatively hard copies can be provided on request. The recommendations are also summarised below for your convenience.

The Portfolio Holder agreed that statutory consultation on this scheme can proceed. Statutory Consultation is the legal process that the council is required to undertake before any changes can be made to any waiting or loading restrictions, or designated parking bays on the public highway. The proposed scheme is set out in the enclosed plans and detailed below as follows:

- A controlled parking zone with operational times of Monday – Friday 8.00 am to 6.30 pm in the following roads:

Argyle Road	Lancaster Road
Blenheim Road	Norfolk Road
Canterbury Road (part)	Northumberland Road (part)
Collapit Close	Somerset Road
Cornwall Road	Suffolk Road
Cumberland Road	Surrey Road
Durham Road	Sussex Road (part)
Gloucester Road	Westmorland Road

- “At any time” waiting restrictions (double yellow lines) introduced throughout the consultation area, at junctions, in turning heads, along narrow sections of carriageway and at bends in accordance with guidance from the Highway Code and undertaking computer simulations of vehicle swept paths.

What happens next?

As mentioned earlier this is the Statutory Consultation stage, which is a legal requirement that the council needs to undertake prior to making a Traffic Management Order and implementing the proposals. The plans have been developed taking into account, where practical, all the comments we received during the previous consultation stages.

This is your opportunity to review the plans in private and make any final comments that you have about the proposal. It will not be possible to add to or increase the extent of the restrictions, as the scheme has been developed using previous resident and business comments. However, minor changes that reduce the scale of the proposals where they do not impact on safety for the wider community may still be possible. Alternatively the changes could be abandoned.

We will advertise the Traffic Management Order by placing notices on street lamp columns and in a local paper on or about **10th July 2014** which will also explain where the plans can be seen. This would give anyone a chance to comment or place a formal objection if they wish to do so by **30th July 2014**.

If there is a significant number of objections to what is proposed which demonstrates a consensus around an alternative suggestion or changes, then, if the objections are upheld it may be necessary to give all

the affected properties in any such area the opportunity to comment on these changes. This will result in a delay in the scheme being implemented in these areas until there is a clear indication that the affected properties agree to the alterations.

The results and any formal objections will be presented to the next available TARSAP meeting for consideration before proceeding to implementation on the agreed measures. It is anticipated that the results will be reported to TARSAP on 2nd October 2014. If there are any formal objections then TARSAP will determine what action needs to be taken. Once approval to proceed has been obtained from the Portfolio Holder the scheme will be given to our contractors to implement and all residents will be informed of the outcome.

Other options provided

Since TARSAP and the Portfolio Holder agreed the proposal the Council has become aware that roads close to and including Northumberland Road would like to see the operating hours of the proposed scheme reduced. The enclosed questionnaire has therefore provided scope for respondents to indicate their view on this issue. It is important to understand that these options are only intended for addressing commuter parking only. These work on the principle that all day parking can be prevented by using operational hours for only 1 or 2 hours per day because the drivers of vehicles intending to leave them unattended for a large part of the day would be deterred. However, these operational hours would not be suitable for tackling parking associated with the commercial centre or other local amenities as this type of parking is more variable and includes short, medium and long term local parking such as shoppers or local employees for example. In this instance the currently proposed all day operational hours would be more suitable for addressing this type of parking problem. It is therefore necessary to consider whether the parking problem is exclusively caused by commuters or if the problems are more complex.

Making a formal statutory objection

Under the legislation which controls the statutory consultation process anyone can make a comment or formal statutory objection to the proposals. However the statutory objection needs to be made in **writing (email is acceptable)** including the word **object** or **objection** (to distinguish it clearly from comments) and the **reason** for the basis of the objection with your name and address. The law sets out a strict timetable for considering formal objections.

Please return your comments by **30th July 2014**. You can submit your comments on-line by visiting www.harrow.gov.uk/trafficconsultations which will direct you to a page containing the survey name North Harrow Statutory Consultation.

Written objections to the scheme proposals should be sent to:

Service Manager - Traffic, Highway and Asset Management
PO Box 39
Civic Centre
Harrow
HA1 2XA

Or by email to transportation@harrow.gov.uk

Quoting ref DP 2014-07 and making sure it is received by 30th July 2014.

More information

If you have any further questions, or wish to comment, please contact the project engineer:

Sajjad Farid
Tel: 020 8424 1484
Email: transportation@harrow.gov.uk

Or write to: Service Manager
Traffic, Highway and Asset Management
Harrow Council, P.O. Box 39
Civic Centre, Harrow HA1 2XA

Please call the number below for a large print version of this document, or a summary of this document in your language.

- Albanian** Nëqoftëse gjuha Angleze nuk është ghuha juaj e parë, dhe keni nevojë për përkthimin e informatave të përmbajtura në këtë dokumentë, ju lutemi kontaktoni numërin dhënë.
- Arabic** اذا كانت الانجليزية ليست لغتك الاولى وتحتاج لترجمة معلومات هذه الوثيقة، الرجاء الاتصال على رقم
- Bengali** যদি ইংরেজি আপনার মাতৃভাষা না হয় এবং আপনি যদি এই প্রচারপত্রের তথ্যগুলোর অনুবাদ পেতে চান তাহলে যে টেলিফোন নম্বর দেওয়া আছে সেখানে দয়া করে যোগাযোগ করুন।
- Chinese** 如果你主要說用的語言不是英語而需要將這份文件的內容翻譯成中文，請打註明的電話號碼提出這個要求。
- Farsi** اگر انگلیسی زبان اول شما نیست و شما نیاز به ترجمه اطلاعات موجود در این مدرک را دارید، لطفاً با شماره داده شده تماس بگیرید
- Gujarati** જો ઈંગ્લિશ તમારી પ્રથમ ભાષા ન હોય અને આ દસ્તાવેજમાં રહેલ માહિતીનો તરજૂમો (ટ્રાન્સલેશન) તમને જોઈતો હોય તો કૃપા કરી જણાવેલ નંબર ઉપર ફોન કરો
- Hindi** यदि आपको अंग्रेजी समझ नहीं आती और आपको इस दस्तावेज़ में दी गई जानकारी का अनुवाद हिन्दी में चाहिए तो कृपया दिए गए नंबर पर फोन करें।
- Punjabi** ਜੇ ਤੁਹਾਨੂੰ ਅੰਗਰੇਜ਼ੀ ਸਮਝ ਨਹੀਂ ਆਉਂਦੀ ਤੇ ਤੁਹਾਨੂੰ ਇਸ ਦਸਤਾਵੇਜ਼ ਵਿਚ ਦਿੱਤੀ ਗਈ ਜਾਣਕਾਰੀ ਦਾ ਤਰਜਮਾ ਪੰਜਾਬੀ ਵਿਚ ਚਾਹੀਦਾ ਹੈ ਤਾਂ ਕਿਰਪਾ ਕਰਕੇ ਦਿੱਤੇ ਗਏ ਨੰਬਰ ਤੇ ਫੋਨ ਕਰੋ।
- Somali** Haddii Ingiriisku uusan ahayn afkaaga koowaad aadna u baahan tahay turjumidda xog ku jirta dokumentigan fadlan la xiriir lambarka lagu siiyey.
- Tamil** ஆங்கிலம் உங்கள் தாய்மொழியாக இல்லாதிருந்து இப்பத்திரத்திலிருக்கும் தகவலின் மொழிபெயர்ப்பு உங்களுக்கு தேவைப்பட்டால் தயவுசெய்து தரப்பட்ட தொலைபேசி எண்ணில் தொடர்பு கொள்ளவும்.
- Urdu** اگر انگریزی آپ کی مادری زبان نہیں ہے اور آپ کو اس دستاویز میں دی گئی معلومات کا اردو ترجمہ درکار ہے، تو براہ کرم دیکھئے گئے نمبر پر رابطہ کریں۔

020 8424 1484

**STATUTORY CONSULTATION IN NORTH HARROW AREA.
- REVIEW OF PARKING CONTROLS QUESTIONNAIRE**

Please complete this questionnaire and return your response by **30th July 2014**. You can also submit your questionnaire on-line by visiting www.harrow.gov.uk/trafficconsultations and then clicking to visit live consultations, which will help the council to be more cost effective and reduce energy consumption. This will direct you to a page containing the **North Harrow Statutory Consultation**. You may be asked to register your details before completing the survey.

Alternatively you may still complete this hard copy and return it using the enclosed prepaid reply envelope (no stamp required), to arrive by **30th July 2014**.

Questionnaires returned without a name and address will not be officially recorded in the results.

First Name Family Name

Business Name (if applicable)

Property Number/Name Street Name

Postcode Date

Please complete the questionnaire by ticking the boxes as appropriate. If you disagree with any of the proposals and wish to object you **must** also write in formally as detailed in the accompanying leaflet. This can be done in the other comments box provided on this form. Simply recording a 'No' response isn't sufficient for this to be treated as a formal statutory objection because legally it is necessary to explain how you are materially affected by the proposals so that the issue can be considered by the portfolio holder.

Before you complete the questionnaire please consider the following. The options in question 3 are for tackling commuter parking only. These work on the principle that all day parking can be prevented by using operational hours for only 1 or 2 hours per day because the drivers of vehicles intending to leave them unattended for a large part of the day would be deterred. However, these operational hours would not be suitable for tackling parking associated with the commercial centre or other local amenities as this type of parking is more variable and includes short, medium and long term local parking such as shoppers or local employees for example. The current all day operational hours proposed would be more appropriate for addressing this type of parking.

Question 1

Do you agree with the proposals for a Mon-Fri 8am- 6:30 pm controlled parking zone contained in this leaflet?

Yes

No

Don't know / No opinion

Question 2 (only if you said 'No' to Question 1)

Since the previous consultation the council has received representations about the current scheme seeking changes to reduce the operating hours of the proposed controlled parking zone. If the operating hours were reduced to a different period of the day would you support the scheme?

Yes

No

Question 3 (only if you said 'Yes' to Question 2)

If you would like to reduce the proposed operating times of the proposed controlled parking zone please select **one** option that you prefer from the list below.

10am – 11am

2pm – 3pm

10am – 11am and 2pm – 3pm

PLEASE NOTE: The double yellow lines are required on safety grounds for emergency vehicle access and reinforce the well established rules of the Highway Code (Rule 243, Revised 2007 Edition). It may be possible to make minor amendments if community safety is not compromised.

Thank you for taking the time to complete this questionnaire.

Unfortunately it is not practical to reply to each individual response, however all comments will be noted and reported to the Traffic and Road Safety Advisory Panel.

If you **DO NOT** want your response to be available for public inspection please tick here.

NOTE: All questionnaire responses and comments will be available in full for the private viewing by the Ward Councillors and the Portfolio Holder for Community Safety and Environment so they will be able to confirm all the comments made by individuals if required.

ANY OTHER COMMENTS

Please use this space to provide any further comments to support your answers to the questionnaire.

EXISTING PINNER CPZ
ZONE A (UNDER REVIEW)

- NOTES:**
- AGREED CONSULTATION AREA
 - PROPOSED CONTROLLED PARKING ZONE Z
(MON-FRI, 8AM TO 6.30PM)
 - PROPOSED LOCATIONS FOR DOUBLE
YELLOW LINES AT JUNCTIONS AND BENDS

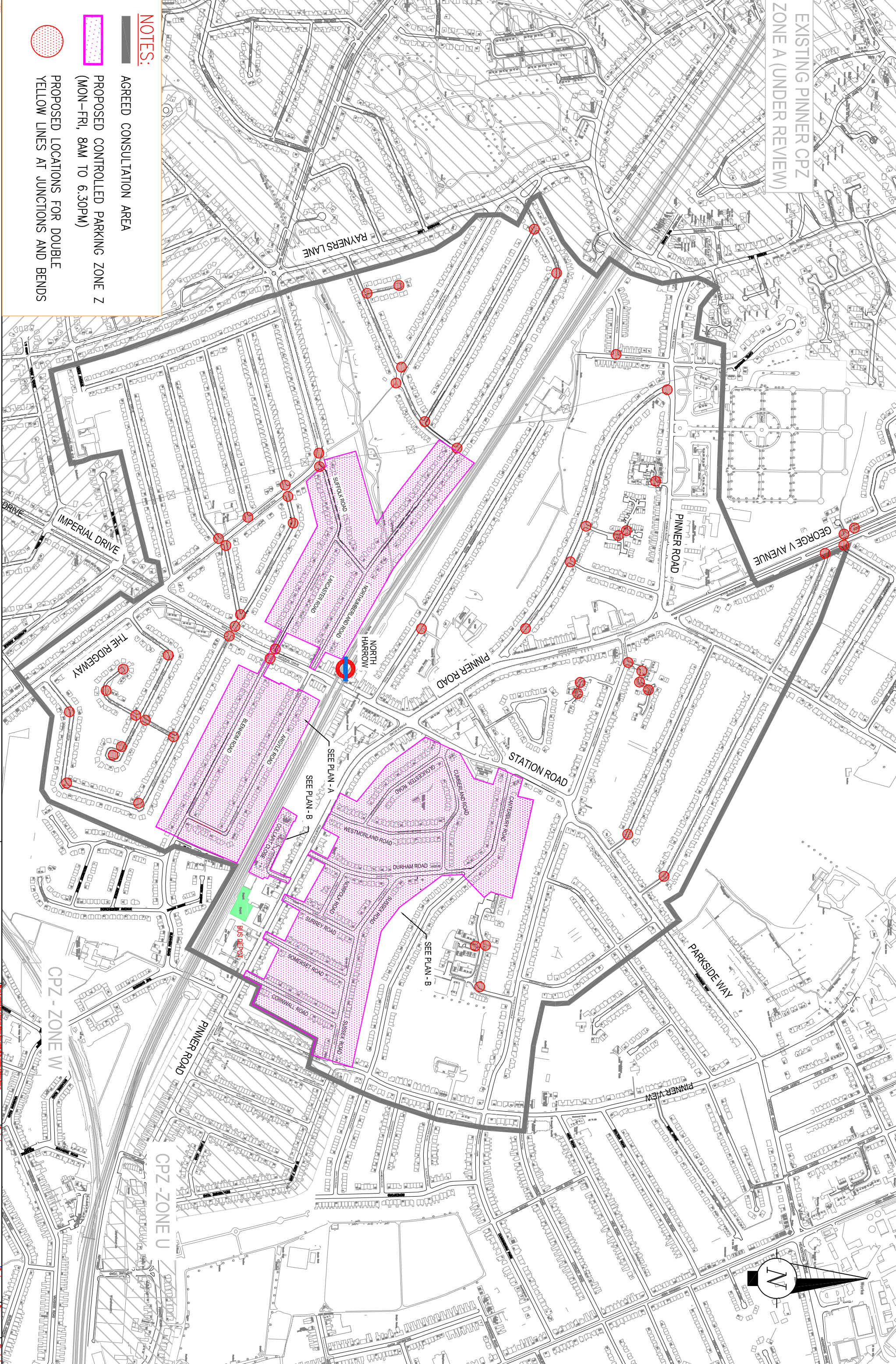







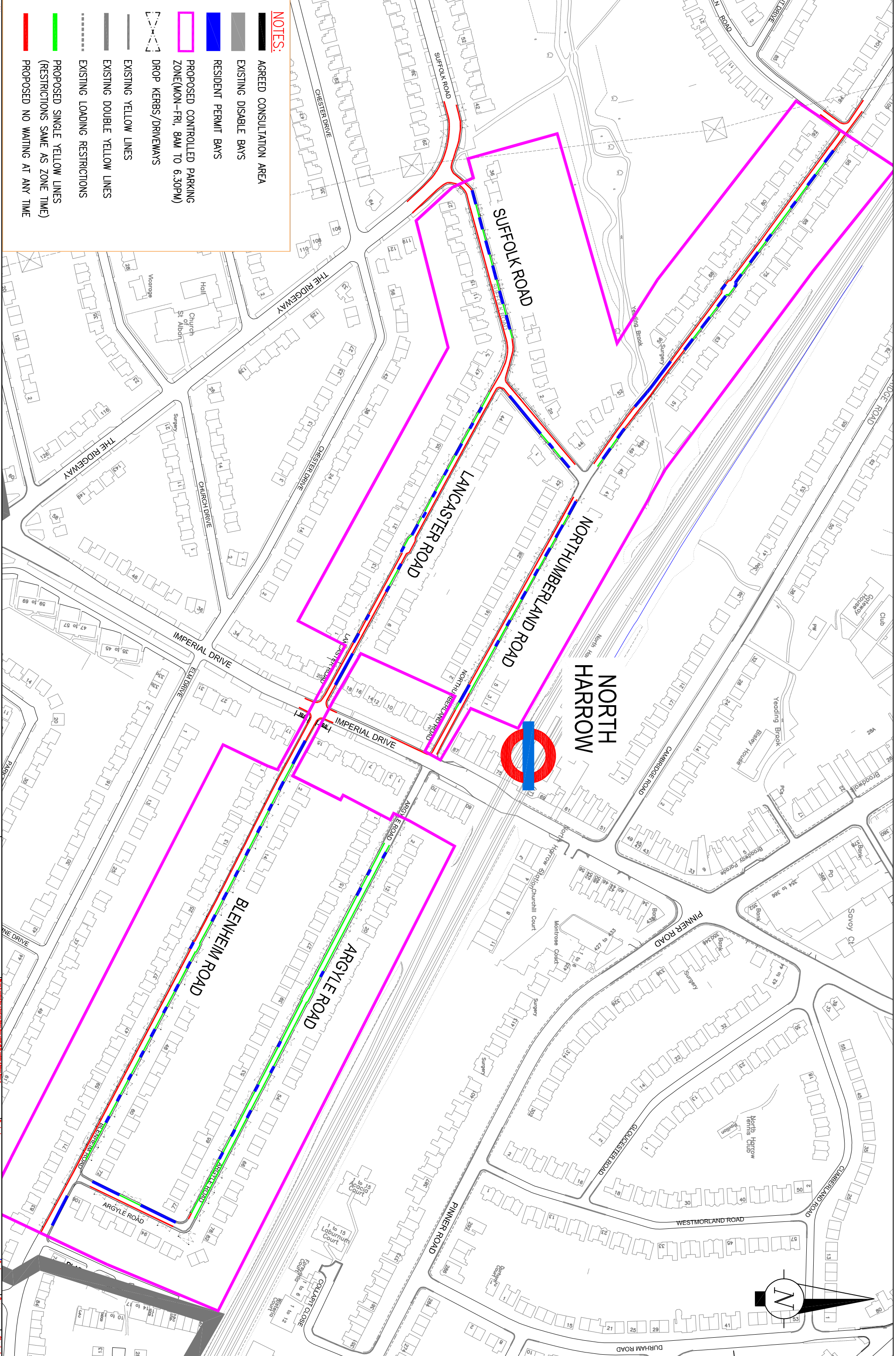
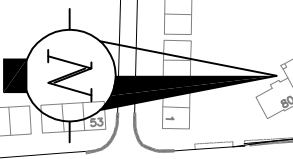



Harrow Council
COMMUNITY & ENVIRONMENT
LONDON
P.O. Box 28, Oak Green
North Harrow, London HA1 2SA
Tel: 020 885 5000
Fax: 020 885 5011

Project	North Harrow Parking Review
Scale	1:1000
Drawn	SAF
Checked	AL
Drawn no	T/DWG/000708
Drawn date	1/3
Project	STATUTORY CONSULTATION KEY PLAN











NOTES:

-  AGREED CONSULTATION AREA
-  EXISTING DISABLE BAYS
-  RESIDENT PERMIT BAYS
-  PROPOSED CONTROLLED PARKING ZONE(MON-FRI, 8AM TO 6.30PM)
-  DROP KERBS/DRIVEWAYS
-  EXISTING YELLOW LINES
-  EXISTING DOUBLE YELLOW LINES
-  EXISTING LOADING RESTRICTIONS
-  PROPOSED SINGLE YELLOW LINES (RESTRICTIONS SAME AS ZONE TIME)
-  PROPOSED NO WAITING AT ANY TIME

Harrow Council
COMMUNITY & ENVIRONMENT
LONDON
P.O. Box 38, Oak Grove
North Harrow, London HA1 2SA
Tel: 020 8869 3111

Model Drawing	1/100/14	SW
Project	NORTH HARROW PARKING REVIEW	
Drawn	SAF	AL
Checked	SAF	AL
Drawn to	1/100/000708	2/3
Submitted to	STATUTORY CONSULTATION PLAN - A	

- NOTES:**
-  AGREED CONSULTATION AREA
 -  EXISTING DISABLE BAYS
 -  RESIDENT PERMIT BAYS
 -  PROPOSED CONTROLLED PARKING ZONE (MON-FRI, 8AM TO 6.30PM)
 -  DROP KERBS/DRIVEWAYS
 -  EXISTING YELLOW LINES
 -  EXISTING DOUBLE YELLOW LINES
 -  EXISTING LOADING RESTRICTIONS
 -  PROPOSED SINGLE YELLOW LINES (RESTRICTIONS SAME AS ZONE TIME)
 -  PROPOSED NO WAITING AT ANY TIME

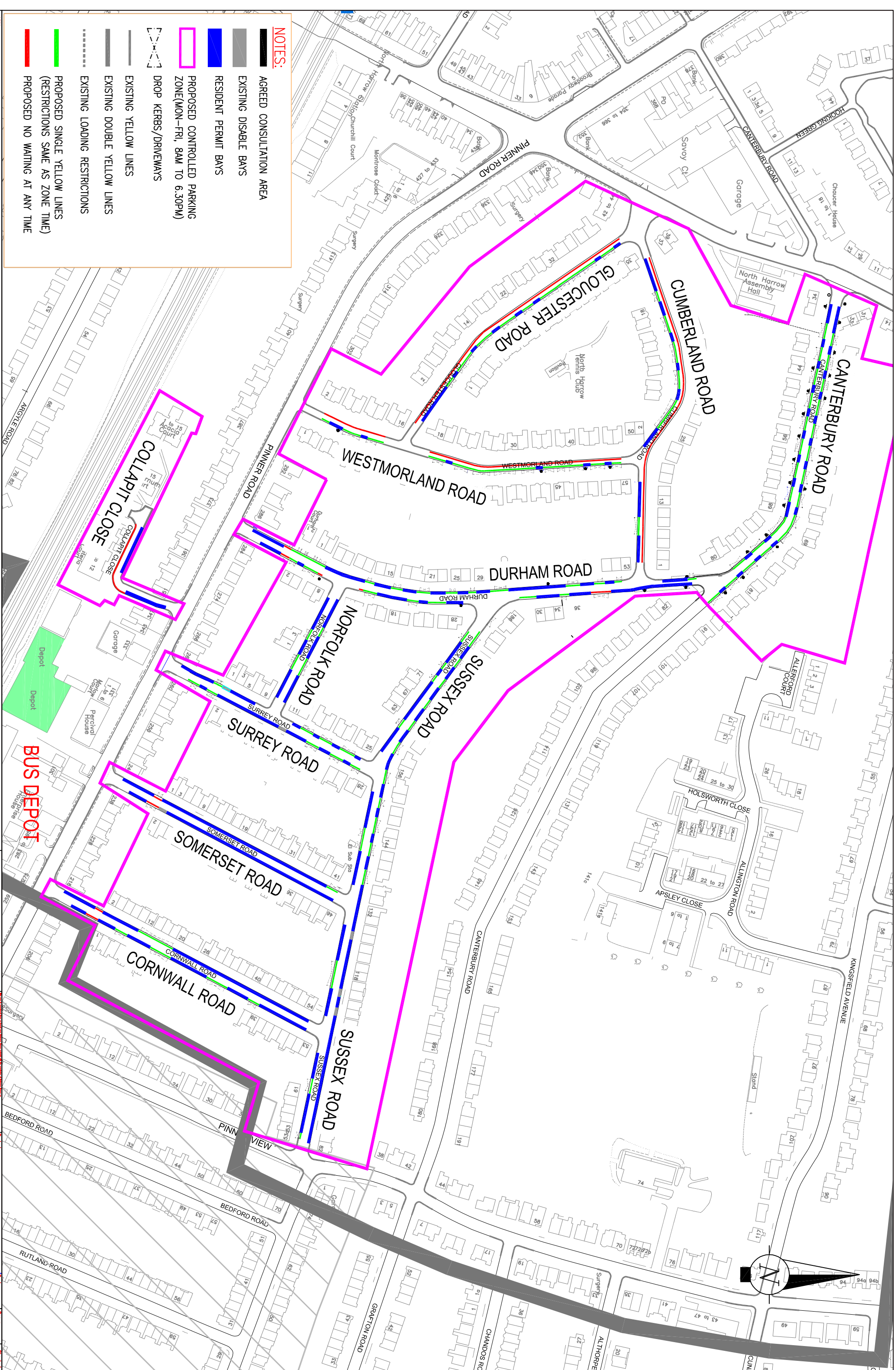

Harrow Council
 COMMUNITY & ENVIRONMENT
 LONDON
 P.O. Box 38, Oak Grove
 North Harrow, London HA1 2SA
 Tel: 020 8846 8111
 Fax: 020 8846 8111

Model Drawing	1/100/1:1
Scale	1:100

Project	NORTH HARROW PARKING REVIEW
Drawn	SAF
Checked	AL
Drawn no	T/DWG/000708
Drawn date	11-06-14
Drawn by	SAF
Drawn for	AL
Drawn on	3/3
Drawn by	SAF
Drawn for	AL
Drawn on	3/3

STATUTORY CONSULTATION
 PLAN - B